

ARDAHAN İLİ HANAK İLÇESİ BİNBAŞAK KÖYÜNDEKİ
106 ADA 169 PARSELDEKİ TESCİLLİ MAĞLİSA DAĞI GÖZETLEME KULESİ ve KORUMA ALANI

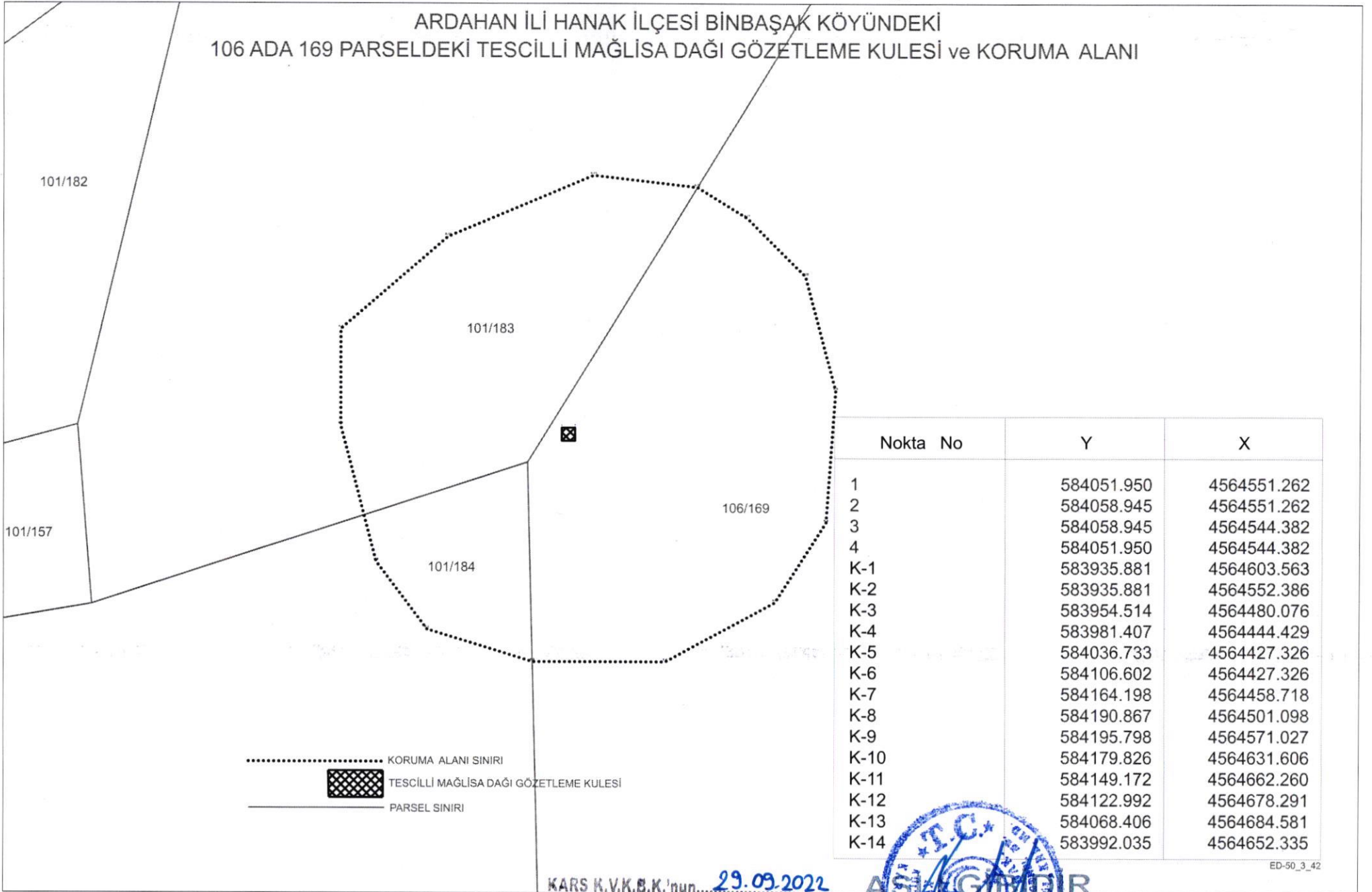

Nokta No	Y	X
1	584051.950	4564551.262
2	584058.945	4564551.262
3	584058.945	4564544.382
4	584051.950	4564544.382
K-1	583935.881	4564603.563
K-2	583935.881	4564552.386
K-3	583954.514	4564480.076
K-4	583981.407	4564444.429
K-5	584036.733	4564427.326
K-6	584106.602	4564427.326
K-7	584164.198	4564458.718
K-8	584190.867	4564501.098
K-9	584195.798	4564571.027
K-10	584179.826	4564631.606
K-11	584149.172	4564662.260
K-12	584122.992	4564678.291
K-13	584068.406	4564684.581
K-14	583992.035	4564652.335

KARS K.V.K.B.K.İnün... 29.09.2022

Tarih ve ... 3648 ... sayılı karar ekidir.



Gökhan CAN
Harita Mühendisi