

KARS İLİ SARIKAMIŞ İLÇESİ KAZIM KARABEKİR MAHALLESİ
203 ADA 6 PARSELDEKİ TESCİLLİ YUKARI SARIKAMIŞ ŞEHİTLİĞİ ve MEZARLIĞIN KORUMA ALANI

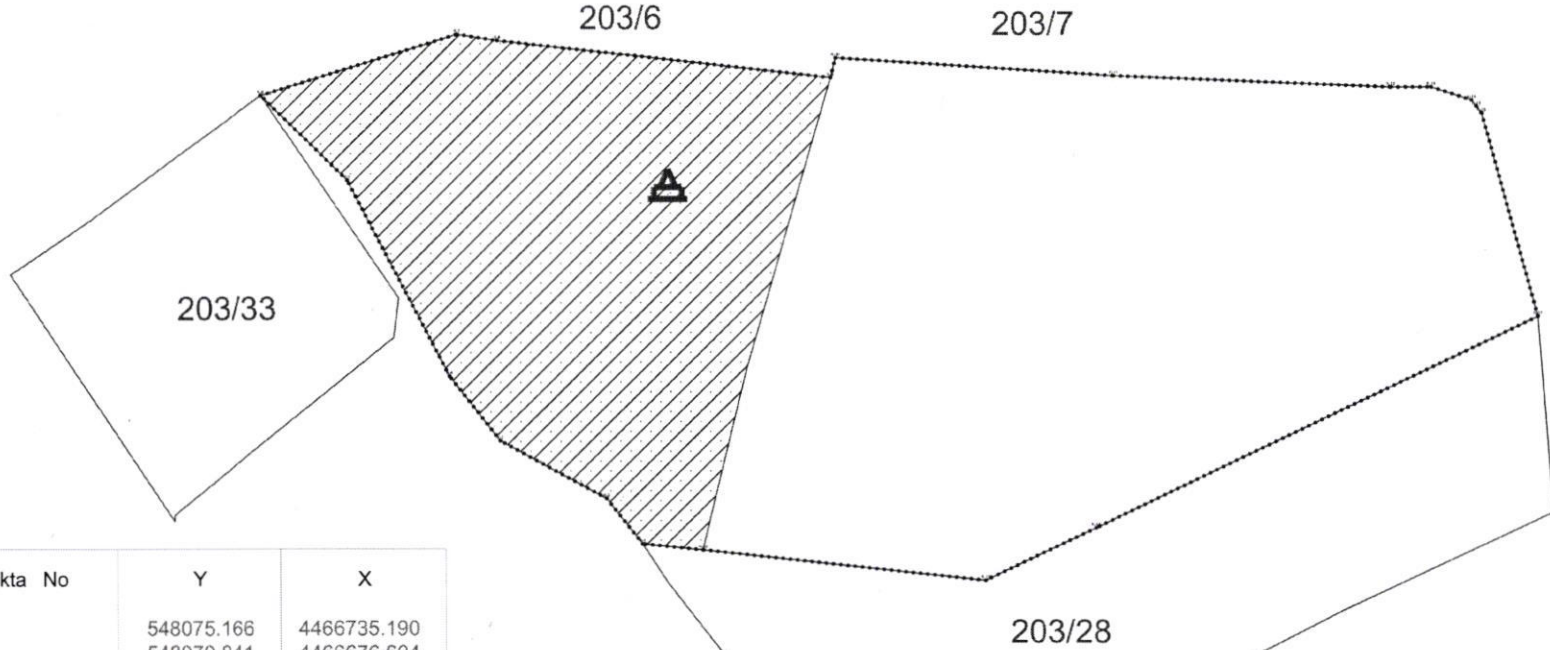

Nokta No	Y	X
1	548075.166	4466735.190
K-1	548070.841	4466676.604
K-2	548064.843	4466684.339
K-3	548046.933	4466694.219
K-4	548038.364	4466705.269
K-5	548021.156	4466738.473
K-6	548006.617	4466752.817
K-7	548039.695	4466763.022
K-8	548046.501	4466761.955
K-9	548102.630	4466755.651
K-10	548103.458	4466758.985
K-11	548150.219	4466755.955
K-12	548196.972	4466754.033
K-13	548203.770	4466754.077
K-14	548210.583	4466751.900
K-15	548211.439	4466750.795
K-16	548212.296	4466749.690
K-17	548221.865	4466715.326
K-18	548147.310	4466679.314
K-19	548128.671	4466670.311
K-20	548081.046	4466675.559

KARS K.V.K.B.K.'nun 28.10.2022

Tarih ve 3676 sayılı karar ekidir.

..... KORUMA ALANI SINIRI

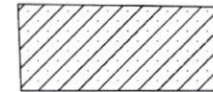

TESCİLLİ MEZARLIK



TESCİLLİ YUKARI SARIKAMIŞ ŞEHİTLİĞİ
PARSEL SINIRI

ED-50_3_42



Gökhan CAN
Harita Mühendisi