

T.C.  
KÜLTÜR VE TURİZM BAKANLIĞI  
HATAY KÜLTÜR VARLIKLARINI KORUMA BÖLGE KURULU  
KARAR

Toplantı Tarihi ve No : 27.01.2021 - 66  
Karar Tarihi ve No : 27.01.2021 - 1093

Toplantı Yeri  
HATAY

Hatay İli, Altınözü İlçesi, Kozkalesi Mahallesi sınırları içinde tespit edilen Gayrimenkul Eski Eserler ve Anıtlar Yüksek Kurulunun 13.11.1981 tarih ve A-3168 sayılı kararı ile tescillenen Koz Kalesi ve Adana Kültür ve Tabiat Varlıklarını Koruma Bölge Kurulunun 11.12.2001 tarih ve 4487 sayılı kararı ile belirlenen korunma alanı sınırlarının sayısallaştırılmasına ilişkin Hatay Kültür Varlıklarını Koruma Bölge Kurulu Müdürlüğü uzmanlarının 26.01.2021 tarih ve 575957 sayı ile kayıtlı raporu okundu, ekleri ve işlem dosyası incelendi, yapılan görüşmeler sonucunda;

Hatay İli, Altınözü İlçesi, Kozkalesi Mahallesi sınırları içinde mülkiyeti Maliye Hazinesine ait olan Koz Kalesinin Gayrimenkul Eski Eserler ve Anıtlar Yüksek Kurulunun 13.11.1981 tarih ve A-3168 sayılı kararı ile tescillendiği, Adana Kültür ve Tabiat Varlıklarını Koruma Bölge Kurulunun 11.12.2001 tarih ve 4487 sayılı karar ile korunma alanının belirlendiği karar eki krokisinde korunma alanına ait koordinatların verilmemesi anlaşılmış olup Koz Kalesi ve Korunma Alanı sınırlarının sayısallaştırılmasına esas kararımız eki 1/10000 ölçekli kadastral harita üzerinde belirlenen sınırların ve koordinatlarının uygun olduğuna, Koz Kalesinin bulunduğu 122 ada 31 parsel **“Tescilli Taşınmaz Kültür Varlığıdır.”** beyanının, Korunma Alanı içerisinde kalan ve kararımız eki kadastral haritada belirtilen 143 ada 1 parsel, 131 ada 8, 9, 11 parsel, 133 ada 2 parsel, 134 ada 84 parsel, 118 ada 7, 9 parsel, 152 ada 1 parsel, 109 ada 153, 167, 171 parsellere **“Bir Bölümü Korunma Alanıdır.”** beyanının, 157 ada 48 parsel, 156 ada 1 parsel, 155 ada 1, 2, 3, 4, 5, 6, 7, 8, 9 parseller 134 ada 1, 2, 3, 4, 5, 6, 7, 8, 9, 10, 11, 12, 13, 14, 15, 16, 17, 18, 19, 20, 21, 22, 23, 24, 25, 26, 27, 82, 83 parseller 138 ada 1, 2, 3, 4, 5, 6 parseller 136 ada 1, 2, 3, 4, 5, 6, 7, 8, 9, 10, 11 parseller 137 ada 1, 2, 3, 4 parseller 135 ada 1 parsel, 123 ada 1, 2, 3, 4, 5, 6, 7, 8, 9, 10, 11, 12, 13, 39, 40, 41, 42, 43, 44, 45, 46, 47, 48, 49, 50, 51, 52, 53, 56, 57, 58, 59, 60, 61, 62, 63, 64, 65, 66, 67, 68, 69, 70, 71, 72 parseller 122 ada 1, 2, 3, 4, 5, 6, 7, 8, 9, 10, 11, 12, 13, 14, 15, 16, 17, 18, 19, 20, 21, 22, 23, 24, 25, 26, 27, 28, 29, 30, 32, 33 parseller 118 ada 1, 2, 3, 4, 5, 6 parseller 154 ada 1, 2, 3, 4, 5, 6, 7, 8, 9, 10, 11, 12, 13, 14, 15, 16, 17, 18, 19, 20, 21, 22, 23, 24, 25, 26, 27, 28, 29, 30, 31, 32, 33, 34, 35, 36, 37, 38, 39, 40, 41, 42, 43, 44, 45, 46, 47, 48, 49 parseller 114 ada 1, 2, 3, 4, 5, 6, 7, 8, 9, 10, 11, 12, 13, 14, 15, 16, 17, 18, 19, 20, 21, 22, 23, 24, 25, 26, 27, 28, 29, 30, 31, 32, 33 parseller 153 ada 1 parsel, 116 ada 1, 2, 3, 4, 5, 6, 7, 8, 9, 10, 11, 12, 13, 14, 15, 16, 17, 18, 19, 20, 21 parseller 115 ada 1, 2, 3, 4, 5, 6, 7 parseller 117 ada 1, 2, 3, 4, 5, 6 parseller 109 ada 154, 155, 156, 157, 158, 159, 160, 161, 162, 163 parsellere **“Tamamı Korunma Alanıdır.”** Şerhinin verilmesinin ilgili Tapu Müdürlüğünden istenmesine sonucundan Hatay Kültür Varlıklarını Koruma Bölge Kurulu Müdürlüğüne bilgi verilmesine karar verildi.

**İLİ: HATAY**  
**İLÇESİ: ALTINÖZÜ**  
**MAHALLE: KOZKALESİ**  
**ADA / PARSEL : MUHTELİF ADA VE PARSELLER**

## KOZ KALESİ VE KORUNMA ALANI

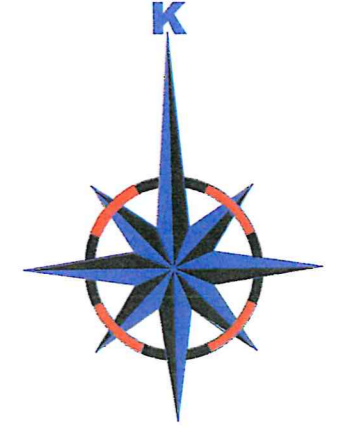

Ölçek:1/10000

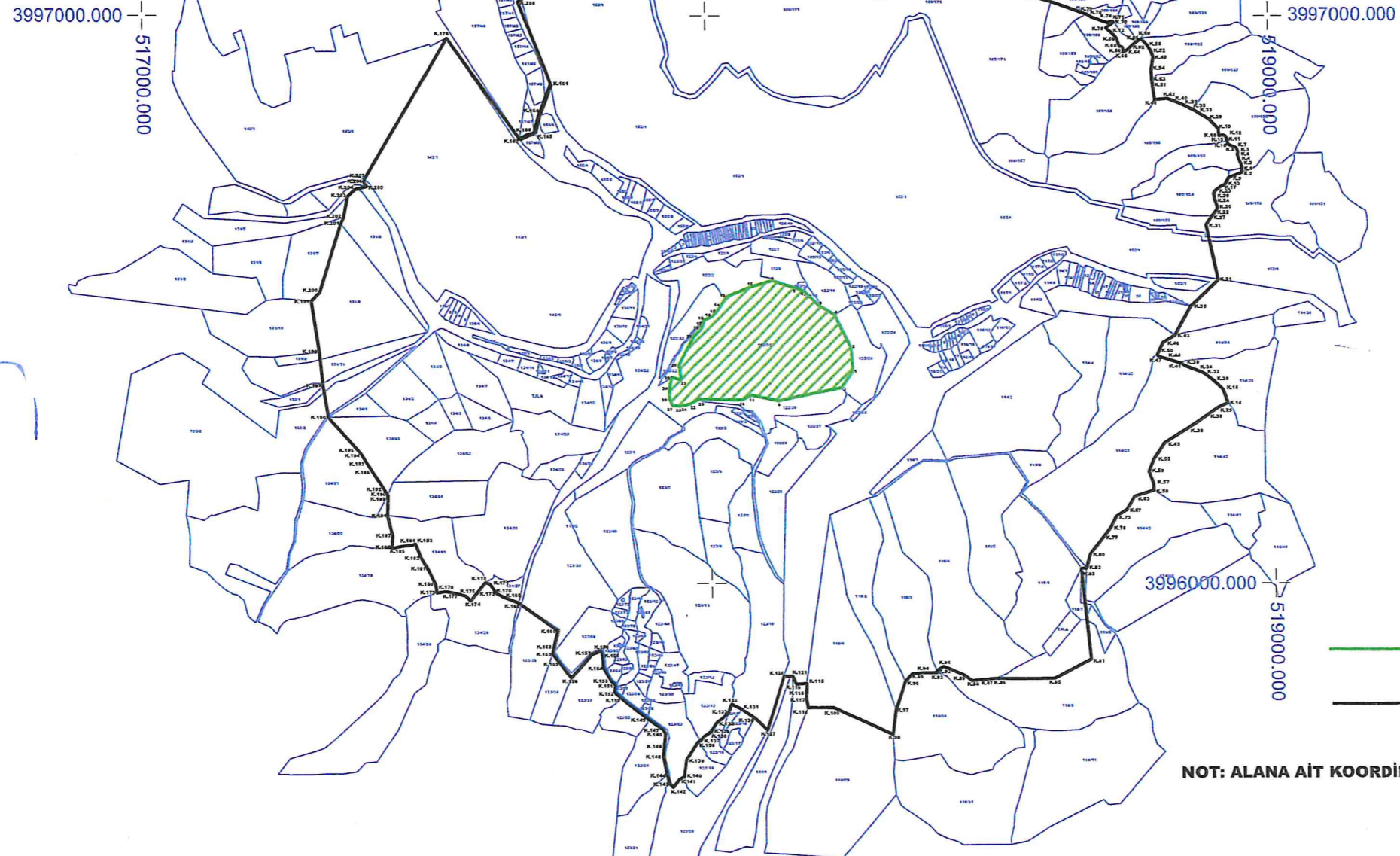

**ASLI GİBİDİR**



HATAY KÜLTÜR VARLIKLARINI  
KORUMA BÖLGE KURULUNUN 27.01.2021  
GÜN VE.....1093.....SAYILI KARAR EKİDİR

**Ercan ALBAK**  
Müze Araştırmacısı

**Mehmet KELEN**  
Harita Teknikeri

**Ezgi AYHAN**  
Harita Mühendisi

## KOZ KALESİ KORUNMA ALANINA AİT KOORDİNATLAR ED50 3 DERECE

Nokta No	Y	X
K.1	518950.724	3996733.991
K.2	518950.293	3996724.845
K.3	518949.178	3996739.295
K.4	518945.469	3996747.661
K.5	518943.975	3996761.098
K.6	518942.678	3996756.694
K.7	518940.899	3996768.186
K.8	518935.572	3996770.665
K.9	518925.942	3996715.836
K.10	518925.582	3996774.907
K.11	518925.159	3996781.724
K.12	518921.898	3996789.102
K.13	518920.294	3996703.860
K.14	518919.081	3996318.877
K.15	518917.603	3996791.010
K.16	518911.724	3996342.220
K.17	518911.081	3996699.445
K.18	518910.407	3996789.613
K.19	518909.666	3996801.552
K.20	518906.101	3996662.969
K.21	518905.173	3996536.260
K.22	518902.470	3996655.966
K.23	518902.281	3996692.822
K.24	518901.628	3996677.937
K.25	518900.810	3996310.366
K.26	518899.910	3996687.775
K.27	518896.090	3996647.797
K.28	518895.506	3996357.756
K.29	518894.363	3996818.024
K.30	518888.137	3996301.256
K.31	518885.804	3996633.281
K.32	518881.707	3996369.263
K.33	518877.050	3996828.978
K.34	518876.409	3996372.812
K.35	518866.066	3996835.936
K.36	518857.983	3996489.071
K.37	518853.556	3996842.239
K.38	518853.034	3996276.120
K.39	518848.287	3996384.146
K.40	518842.890	3996847.193
K.41	518839.887	3996389.084
K.42	518830.189	3996438.375
K.43	518823.669	3996854.976
K.44	518816.139	3996396.730
K.45	518809.771	3996248.213
K.46	518809.185	3996425.632
K.47	518803.878	3996400.140
K.48	518801.146	3996852.988
K.49	518799.673	3996927.077
K.50	518799.042	3996403.506
K.51	518798.283	3996876.021
K.52	518796.774	3996935.746
K.53	518796.735	3996887.105
K.54	518795.515	3996905.031
K.55	518791.148	3996220.208
K.56	518790.368	3996946.715
K.57	518789.930	3996176.868
K.58	518789.648	3996164.676
K.59	518781.567	3996198.319

Nokta No	Y	X
K.60	518778.618	3996959.737
K.61	518769.729	3996953.882
K.62	518760.458	3996946.365
K.63	518754.580	3996153.795
K.64	518754.532	3996941.072
K.65	518746.085	3996936.382
K.66	518745.020	3996944.692
K.67	518740.882	3996131.057
K.68	518739.059	3996947.011
K.69	518733.969	3996961.037
K.70	518728.704	3996988.488
K.71	518727.050	3996990.672
K.72	518724.750	3996970.923
K.73	518721.381	3996118.847
K.74	518718.033	3996988.083
K.75	518715.079	3996978.488
K.76	518711.348	3996998.784
K.77	518699.946	3996084.138
K.78	518689.759	3996997.780
K.79	518682.001	3997002.485
K.80	518674.288	3996051.776
K.81	518673.491	3995866.005
K.82	518667.184	3996027.260
K.83	518657.931	3996025.897
K.84	518619.424	3997024.462
K.85	518608.313	3995831.403
K.86	518503.845	3995831.403
K.87	518484.678	3995829.894
K.88	518461.004	3995827.959
K.89	518446.885	3995837.835
K.90	518413.665	3997080.497
K.91	518410.034	3995853.242
K.92	518397.979	3995842.317
K.93	518397.914	3995845.614
K.94	518372.223	3995841.863
K.95	518351.721	3995839.603
K.96	518339.699	3995825.799
K.97	518322.106	3995775.731
K.98	518316.454	3995732.724
K.99	518306.472	3997038.790
K.100	518300.647	3997064.115
K.101	518297.927	3997052.498
K.102	518281.114	3997077.187
K.103	518264.538	3997085.502
K.104	518264.264	3997102.335
K.105	518263.642	3997128.874
K.106	518245.541	3997109.055
K.107	518240.474	3997123.081
K.108	518239.672	3997136.270
K.109	518214.471	3995779.656
K.110	518213.995	3997096.444
K.111	518213.480	3997101.247
K.112	518204.030	3997091.451
K.113	518195.672	3997097.239
K.114	518169.051	3995779.849
K.115	518167.237	3995822.902
K.116	518166.515	3995804.199
K.117	518166.097	3995793.977
K.118	518160.303	3997118.312

Nokta No	Y	X
K.119	518148.753	3995821.071
K.120	518143.564	3997104.812
K.121	518141.936	3995835.381
K.122	518135.715	3997093.240
K.123	518128.129	3997080.909
K.124	518126.351	3995835.249
K.125	518116.869	3997099.748
K.126	518103.234	3997105.451
K.127	518093.721	3995740.228
K.128	518093.476	3997112.074
K.129	518084.202	3997128.805
K.130	518070.990	3995761.796
K.131	518049.722	3995776.149
K.132	518030.790	3995785.975
K.133	518025.636	3995769.798
K.134	518004.604	3995752.811
K.135	517994.278	3995736.800
K.136	517983.393	3995729.177
K.137	517978.024	3995722.858
K.138	517972.677	3995716.504
K.139	517951.577	3995686.863
K.140	517947.156	3995657.742
K.141	517938.307	3995652.537
K.142	517927.167	3995638.471
K.143	517922.316	3995644.333
K.144	517917.627	3995660.361
K.145	517915.516	3995733.519
K.146	517912.762	3995710.077
K.147	517911.451	3995740.608
K.148	517911.140	3995692.611
K.149	517884.121	3995760.347
K.150	517836.669	3995796.448
K.151	517826.358	3995619.861
K.152	517824.985	3995806.711
K.153	517818.786	3995826.517
K.154	517805.175	3995849.220
K.155	517802.936	3995874.194
K.156	517800.567	3995880.082
K.157	517783.849	3995873.545
K.158	517747.668	3995832.359
K.159	517728.090	3995858.199
K.160	517725.125	3995916.032
K.161	517724.593	3996881.274
K.162	517717.700	3995884.925
K.163	517716.144	3995874.778
K.164	517701.793	3996822.795
K.165	517694.480	3996795.016
K.166	517683.744	3996792.692
K.167	517668.393	3996784.792
K.168	517656.844	3995965.506
K.169	517630.000	3995975.883
K.170	517617.844	3995982.314
K.171	517606.821	3995998.835
K.172	517599.142	3996000.827
K.173	517584.207	3995982.598
K.174	517573.188	3995968.883
K.175	517564.372	3995977.508
K.176	517541.798	3996960.430
K.177	517547.586	3995981.910

Nokta No	Y	X
K.178	517529.671	3995985.505
K.179	517513.592	3995983.018
K.180	517511.263	3995998.390
K.181	517496.157	3996027.951
K.182	517485.544	3996045.986
K.183	517476.337	3996069.469
K.184	517469.975	3996067.536
K.185	517452.062	3996065.257
K.186	517401.551	3996197.211
K.187	517436.175	3996083.372
K.188	517434.276	3996061.626
K.189	517428.906	3996154.487
K.190	517428.909	3996154.473
K.191	517427.686	3996119.088
K.192	517421.783	3996166.461
K.193	517391.490	3996212.554
K.194	517381.958	3996228.062
K.195	517374.840	3996236.249
K.196	517324.277	3996292.752
K.197	517315.648	3996347.473
K.198	517309.368	3996407.476
K.199	517296.382	3996498.420
K.200	517311.384	3996513.709
K.201	517350.154	3996634.647
K.202	517355.386	3996645.879
K.203	517362.953	3996682.652
K.204	517376.626	3996695.357
K.205	517397.627	3996700.557
K.206	517392.098	3996707.670
K.207	517393.140	3996712.850
K.208	517667.993	3997024.416
K.209	517910.095	3997180.443
K.210	517921.741	3997183.051
K.211	517937.095	3997189.080
K.212	517960.669	3997195.303
K.213	517974.555	3997196.300
K.214	517991.984	3997196.486
K.215	518016.084	3997198.814
K.216	518051.683	3997197.626
K.217	518050.423	3997176.549
K.218	518064.933	3997159.645
K.219	518072.915	3997145.025

Hatay Kültür Varlıklarını  
Koruma Bölge Kurulunun  
27.01.2021 gün ve 1093...  
sayılı karar ekidir.

### TESCİLLİ TAŞINMAZ KÜLTÜR VARLIĞINA AİT KOORDİNATLAR ED50 3 DERECE

Nokta No	Y	X
1	518255.434	3996374.866
2	518252.749	3996416.042
3	518235.644	3996345.014
4	518224.896	3996473.442
5	518197.085	3996490.904
6	518171.336	3996516.335
7	518156.779	3996521.504
8	518121.879	3996321.964
9	518113.009	3996534.331
10	518074.693	3996523.274
11	518073.411	3996332.152
12	518056.265	3996323.729
13	518031.281	3996505.735
14	518020.068	3996487.950
15	518010.136	3996474.786
16	518003.056	3996469.052
17	517991.616	3996460.223
18	517990.750	3996463.996
19	517987.934	3996449.784
20	517982.419	3996325.159
21	517973.250	3996434.234
22	517966.698	3996316.351
23	517950.466	3996358.687
24	517949.514	3996313.051
25	517946.508	3996312.600
26	517946.437	3996385.014
27	517935.488	3996313.332
28	517933.662	3996363.185
29	517929.430	3996325.640
30	517929.202	3996343.639



WA SA  
MK

## KOZ KALESİ KORUNMA ALANINA AİT KOORDİNATLAR ITRF96 3 DERECE

Nokta No	Y	X
K.1	518922.445	3996560.509
K.2	518922.014	3996551.363
K.3	518920.900	3996565.813
K.4	518917.190	3996574.179
K.5	518915.697	3996587.615
K.6	518914.399	3996583.212
K.7	518912.620	3996594.703
K.8	518907.294	3996597.183
K.9	518897.664	3996542.354
K.10	518897.304	3996601.424
K.11	518896.880	3996608.241
K.12	518893.619	3996615.619
K.13	518892.015	3996530.378
K.14	518890.802	3996145.397
K.15	518889.325	3996617.527
K.16	518883.445	3996168.740
K.17	518882.803	3996525.963
K.18	518882.129	3996616.130
K.19	518881.387	3996628.069
K.20	518877.822	3996489.488
K.21	518876.895	3996362.780
K.22	518874.192	3996482.485
K.23	518874.002	3996519.340
K.24	518873.350	3996504.455
K.25	518872.532	3996136.887
K.26	518871.632	3996514.293
K.27	518867.812	3996474.316
K.28	518867.227	3996184.277
K.29	518866.085	3996644.541
K.30	518859.859	3996127.777
K.31	518857.526	3996459.799
K.32	518853.429	3996195.783
K.33	518848.772	3996655.495
K.34	518848.131	3996199.333
K.35	518837.788	3996662.453
K.36	518829.705	3996315.590
K.37	518825.278	3996668.756
K.38	518824.756	3996102.641
K.39	518820.009	3996210.667
K.40	518814.612	3996673.710
K.41	518811.609	3996215.605
K.42	518801.912	3996264.895
K.43	518795.391	3996681.493
K.44	518787.862	3996223.250
K.45	518781.494	3996074.734
K.46	518780.907	3996252.152
K.47	518775.601	3996226.660
K.48	518772.868	3996679.505
K.49	518771.396	3996753.593
K.50	518770.765	3996230.026
K.51	518770.006	3996702.538
K.52	518768.497	3996762.262
K.53	518768.457	3996713.622
K.54	518767.237	3996731.548
K.55	518762.871	3996046.730
K.56	518762.091	3996773.231
K.57	518761.652	3996003.389
K.58	518761.370	3995991.197
K.59	518753.289	3996024.841

Nokta No	Y	X
K.60	518750.341	3996786.253
K.61	518741.451	3996780.398
K.62	518732.181	3996772.681
K.63	518726.303	3995980.317
K.64	518726.254	3996767.589
K.65	518717.808	3996762.899
K.66	518716.743	3996771.209
K.67	518712.604	3995957.579
K.68	518710.782	3996773.527
K.69	518705.691	3996787.554
K.70	518700.427	3996815.004
K.71	518698.773	3996817.188
K.72	518696.473	3996797.439
K.73	518693.104	3995945.369
K.74	518689.756	3996814.599
K.75	518686.802	3996805.004
K.76	518683.071	3995925.306
K.77	518671.669	3995910.660
K.78	518661.482	3996824.296
K.79	518653.724	3996829.000
K.80	518646.011	3995878.299
K.81	518645.214	3995692.529
K.82	518638.907	3995853.782
K.83	518629.655	3995852.420
K.84	518591.147	3996850.978
K.85	518580.037	3995657.927
K.86	518475.569	3995657.927
K.87	518456.403	3995656.418
K.88	518432.728	3995654.484
K.89	518418.610	3995664.359
K.90	518385.390	3996907.012
K.91	518381.759	3995679.766
K.92	518369.704	3995668.841
K.93	518369.639	3995672.139
K.94	518343.948	3995668.387
K.95	518323.447	3995666.127
K.96	518311.424	3995652.323
K.97	518293.832	3995602.255
K.98	518288.180	3995559.249
K.99	518278.198	3996865.306
K.100	518272.373	3996890.631
K.101	518269.653	3996879.013
K.102	518252.840	3996903.702
K.103	518236.264	3996912.017
K.104	518235.991	3996928.850
K.105	518235.369	3996955.389
K.106	518217.267	3996935.571
K.107	518212.200	3996949.596
K.108	518211.398	3996962.785
K.109	518186.197	3995606.180
K.110	518185.722	3996922.959
K.111	518185.206	3996927.762
K.112	518175.757	3996917.966
K.113	518167.399	3996923.754
K.114	518140.778	3995606.373
K.115	518138.964	3995649.426
K.116	518138.242	3995630.723
K.117	518137.823	3995620.502
K.118	518132.030	3996944.827

Nokta No	Y	X
K.119	518120.480	3995647.596
K.120	518115.291	3996931.328
K.121	518113.663	3995661.905
K.122	518107.442	3996919.755
K.123	518099.856	3996907.424
K.124	518098.078	3995661.773
K.125	518088.596	3996926.263
K.126	518074.961	3996931.966
K.127	518065.448	3995666.753
K.128	518065.203	3996938.589
K.129	518055.930	3996955.320
K.130	518042.717	3995588.321
K.131	518021.449	3995602.674
K.132	518002.517	3995612.500
K.133	517997.363	3995596.323
K.134	517976.332	3995579.336
K.135	517966.006	3995563.325
K.136	517955.121	3995555.702
K.137	517949.752	3995549.383
K.138	517944.405	3995545.029
K.139	517923.305	3995513.388
K.140	517918.884	3995484.267
K.141	517910.035	3995479.063
K.142	517898.895	3995464.997
K.143	517894.044	3995470.859
K.144	517889.355	3995486.886
K.145	517887.244	3995560.044
K.146	517884.490	3995536.602
K.147	517883.180	3995567.133
K.148	517882.869	3995549.136
K.149	517855.850	3995586.872
K.150	517808.398	3995622.972
K.151	517798.087	3995646.385
K.152	517796.715	3995633.236
K.153	517790.516	3995653.042
K.154	517776.904	3995675.744
K.155	517774.666	3995700.718
K.156	517772.296	3995706.606
K.157	517755.578	3995700.068
K.158	517719.397	3995658.883
K.159	517699.819	3995684.723
K.160	517696.855	3995742.556
K.161	517696.323	3996707.791
K.162	517689.430	3995711.449
K.163	517687.874	3995701.302
K.164	517673.523	3996649.312
K.165	517666.210	3996621.533
K.166	517655.474	3996619.209
K.167	517640.123	3996611.310
K.168	517628.575	3995792.029
K.169	517601.730	3995802.406
K.170	517589.574	3995808.837
K.171	517578.552	3995825.358
K.172	517570.872	3995827.350
K.173	517555.938	3995809.121
K.174	517544.919	3995795.406
K.175	517536.103	3995804.031
K.176	517513.530	3996786.947
K.177	517519.317	3995808.433

Nokta No	Y	X
K.178	517501.402	3995812.028
K.179	517485.323	3995809.541
K.180	517482.994	3995824.913
K.181	517467.888	3995854.474
K.182	517457.275	3995872.509
K.183	517448.068	3995895.992
K.184	517441.706	3995894.059
K.185	517423.793	3995891.780
K.186	517373.283	3996023.733
K.187	517407.907	3995909.894
K.188	517406.008	3995888.149
K.189	517400.638	3995981.009
K.190	517400.641	3995980.995
K.191	517399.418	3995945.611
K.192	517393.515	3995992.983
K.193	517363.222	3996039.076
K.194	517353.690	3996054.584
K.195	517346.572	3996062.770
K.196	517296.009	3996119.273
K.197	517287.381	3996173.994
K.198	517281.100	3996233.896
K.199	517268.115	3996324.939
K.200	517283.117	3996340.229
K.201	517321.886	3996461.165
K.202	517327.118	3996472.398
K.203	517334.685	3996509.170
K.204	517348.358	3996521.876
K.205	517369.359	3996527.075
K.206	517363.830	3996534.188
K.207	517364.872	3996539.368
K.208	517639.723	3996850.932
K.209	517881.823	3997006.958
K.210	517893.470	3997009.566
K.211	517908.824	3997015.595
K.212	517932.398	3997021.817
K.213	517946.283	3997022.815
K.214	517963.712	3997023.001
K.215	517987.812	3997025.328
K.216	518023.411	3997024.141
K.217	518022.151	3997003.063
K.218	518036.661	3996986.160
K.219	518044.643	3996971.539

Hatay Kültür Varlıklarını  
Koruma Bölge Kurulunun  
27.01.2021 gün ve...1093...  
sayılı karar ekidir.

## TESCİLLİ TAŞINMAZ KÜLTÜR VARLIĞINA AİT KOORDİNATLAR ITRF96 3 DERECE

Nokta No	Y	X
1	518227.160	3996201.386
2	518224.475	3996242.562
3	518207.370	3996171.534
4	518196.622	3996299.962
5	518168.811	3996317.423
6	518143.063	3996342.854
7	518128.506	3996348.024
8	518093.606	3996148.485
9	518084.736	3996360.851
10	518046.420	3996349.794
11	518045.138	3996158.673
12	518027.993	3996150.250
13	518003.009	3996332.254
14	517991.796	3996314.470
15	517981.864	3996301.306
16	517974.784	3996295.572
17	517963.344	3996286.743
18	517962.478	3996290.516
19	517959.662	3996276.304
20	517954.147	3996151.680
21	517944.978	3996260.754
22	517938.426	3996142.872
23	517922.195	3996185.208
24	517921.242	3996139.572
25	517918.236	3996139.121
26	517918.165	3996211.535
27	517907.216	3996139.853
28	517905.390	3996189.705
29	517901.159	3996152.160
30	517900.931	3996170.159



EK  
M.K