

KARS İLİ SARIKAMIŞ İLÇESİ KARAPINAR KÖYÜ
105 ADA 71 PARSELDEKİ TESCİLLİ KAYA KİLİSE ve KORUMA ALANI

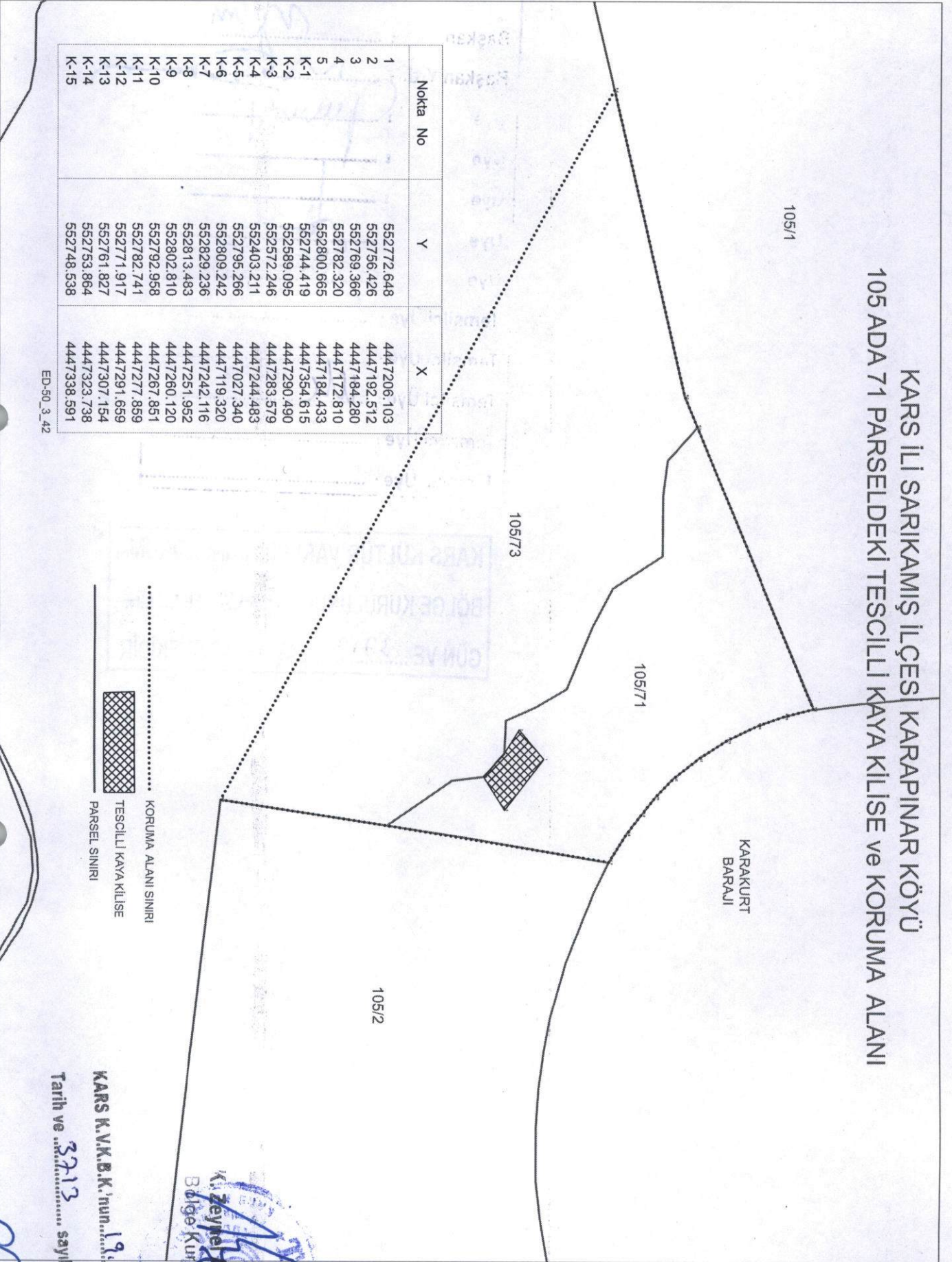

Nokta No	Y	X
1	552772.648	4447206.103
2	552756.426	4447192.512
3	552769.366	4447184.280
4	552782.320	4447172.810
5	552800.665	4447184.433
K-1	552744.419	4447354.615
K-2	552589.095	4447290.490
K-3	552572.246	4447283.579
K-4	552403.211	4447244.483
K-5	552795.266	4447027.340
K-6	552809.242	4447119.320
K-7	552829.236	4447242.116
K-8	552813.483	4447251.952
K-9	552802.810	4447260.120
K-10	552792.958	4447267.851
K-11	552782.741	4447277.859
K-12	552771.917	4447291.659
K-13	552761.827	4447307.154
K-14	552753.864	4447323.738
K-15	552748.538	4447338.591

ED-50_3_42

..... KORUMA ALANI SINIRI
TESCİLLİ KAYA KİLİSE
PARSEL SINIRI

KARS K.V.K.B.K.'nın 19.12.2022
Tarih ve 3713 sayılı karar ekidir.

K. Zeynelabidin PASLI
Bölge Kurul Başkanı

GÖKALP GÖKALP
Harita Mühendisi