

KARS İLİ MERKEZ İLÇESİ ÖRNEK MAHALLESİ
476 ADA 514 PARSELDEKİ TESCİLLİ KANLITABYA ve KORUMA ALANI

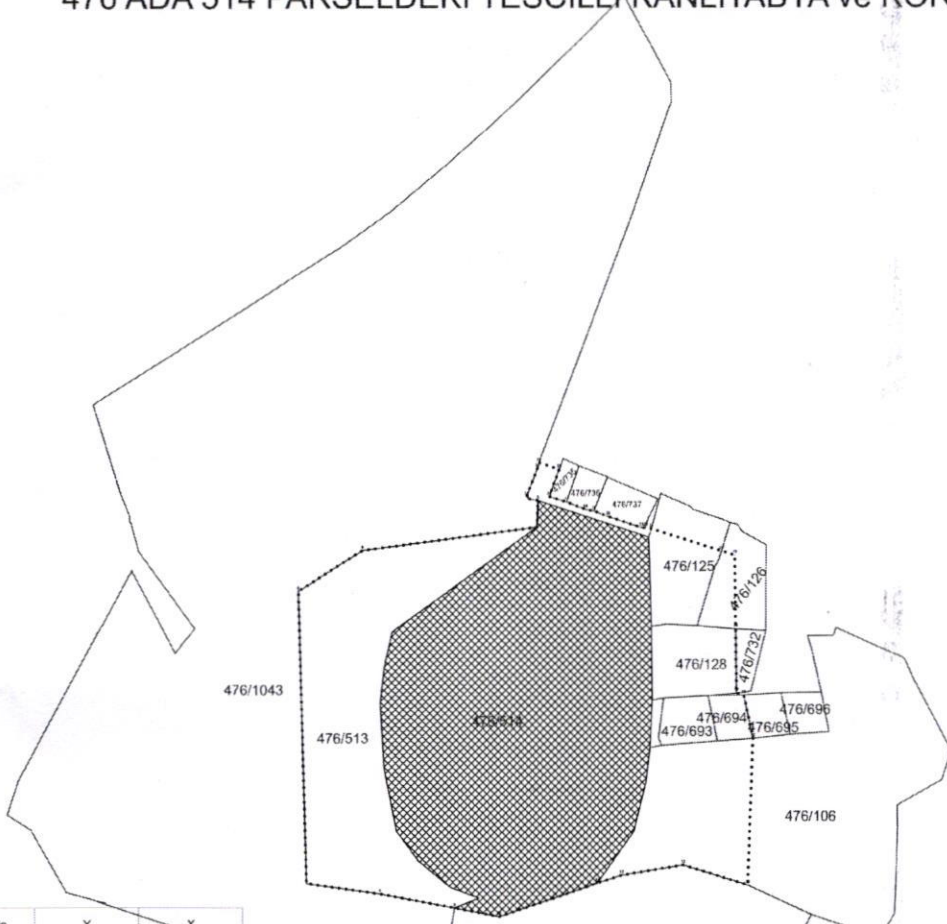

Nokta No	Y	X
1	592786.156	4496001.307
2	592786.173	4496000.791
3	592792.112	4495999.754
4	592791.459	4495998.199
5	592988.332	4495970.696
6	592650.527	4495948.902
7	592655.192	4495775.917
8	592998.450	4495769.791
9	592742.563	4495761.454
10	592768.696	4495756.228
11	592827.074	4495775.834
12	592841.411	4495780.455
13	592877.744	4495785.481
14	592915.693	4495774.720
15	592919.160	4495860.281
16	592913.762	4495885.799
17	592909.515	4495888.817
18	592909.045	4495924.574
19	592906.549	4495967.671
20	592900.638	4495970.160
21	592859.283	4495983.172
22	592855.811	4495983.887
23	592853.271	4495983.055
24	592833.718	4495990.270
25	592825.211	4495993.502
26	592820.118	4495994.549
27	592909.057	4495998.854
28	592798.857	4496002.059
29	592804.717	4496018.027
30	592792.682	4496021.974
31	592791.877	4496018.632
32	592785.312	4496001.800

ED-50_3_42



KARS K.V.K.B.K.'nun...31.01.2022

Tarih ve ...3492... sayılı karar ekidir.

Gökhan CAN
Harita Mühendisi