

KARS İLİ SARIKAMIŞ İLÇESİ İNÖNÜ MAHALLESİ
582 ADA 44 PARSELDEKİ TESCİLLİ ŞEHİT MEZARLARI ve KORUMA ALANI

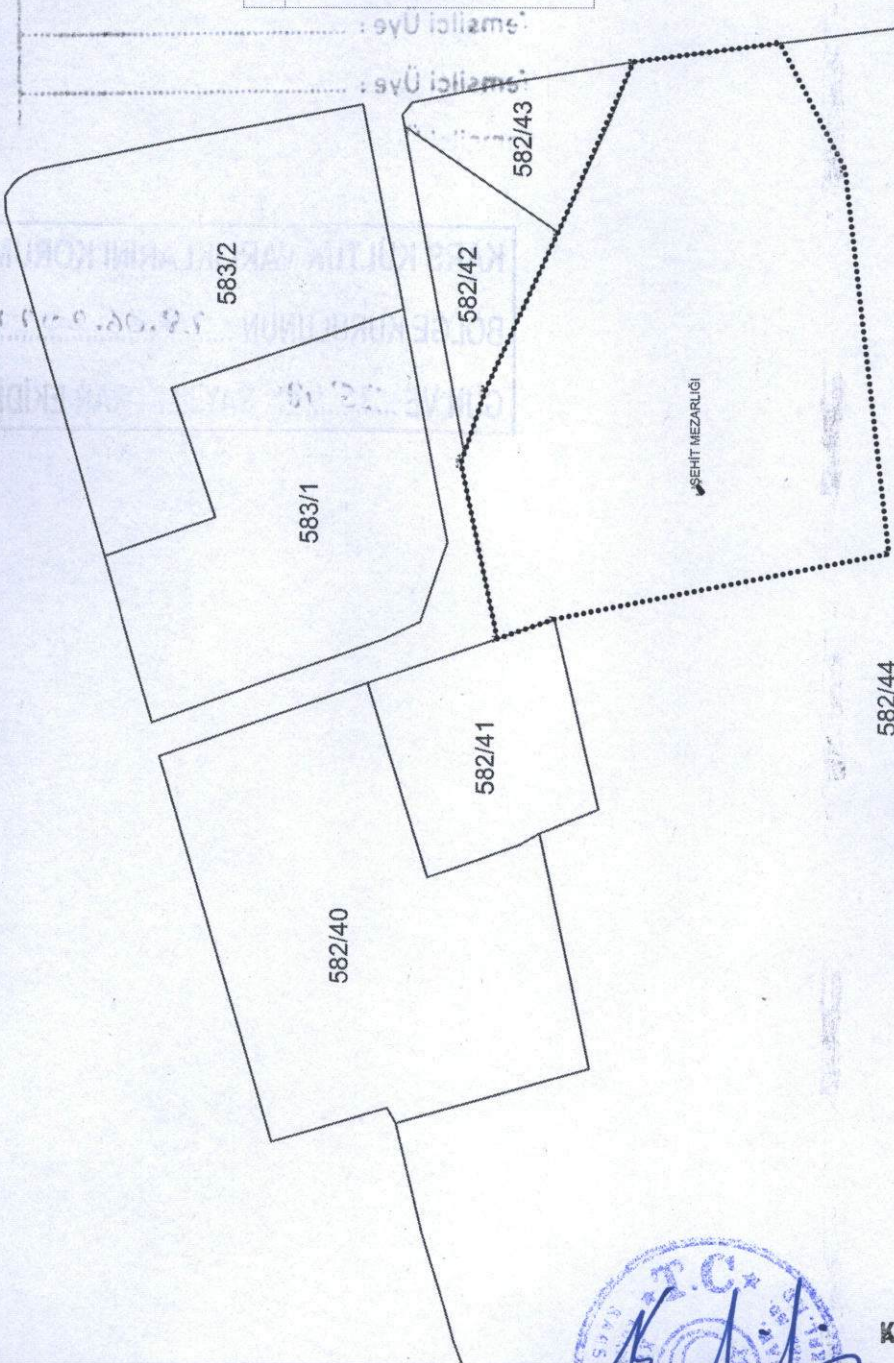

Nokta No	Y	X
1	550472.873	4466316.547
2	550472.351	4466317.177
3	550473.928	4466318.148
4	550474.309	4466317.589
K-1	550440.364	4466362.389
K-2	550444.679	4466349.692
K-3	550459.284	4466275.786
K-4	550544.382	4466285.491
K-5	550572.301	4466299.878
K-6	550568.053	4466332.249
K-7	550530.287	4466348.939
K-8	550495.770	4466364.879
K-9	550480.434	4466370.026
K-10	550479.238	4466370.417

ED-50_3_42

..... KORUMA ALANI SINIRI
▨ TESCİLLİ ŞEHİT MEZARLAR
—— PARSEL SINIRI

K. Zeynel Abidin YAŞLI
Bölge Kurulu Müdürü

KARS K.V.K.B.K.'nun 28.06.2022
Tarih ve 3568 sayılı karar ekidir.